

REVISION HISTORY						
ZONE	REV	ECO	DESCRIPTION	BY	DATE	APPROVED
	01		INITIAL RELEASE			

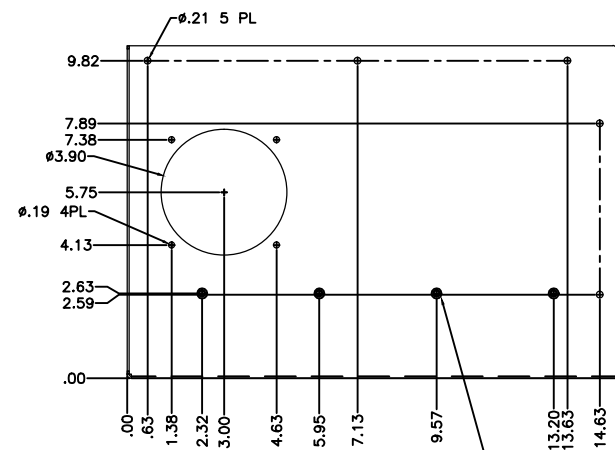
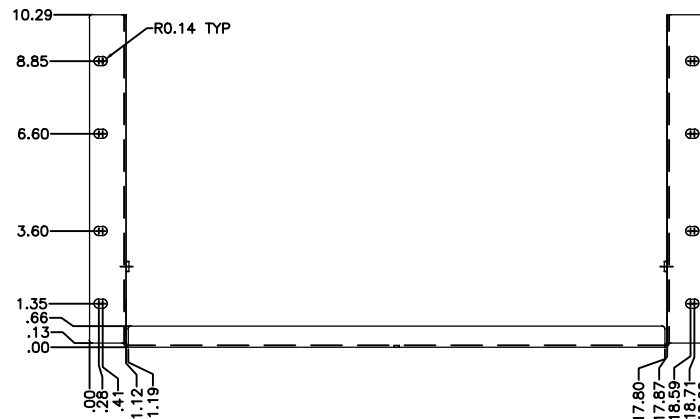
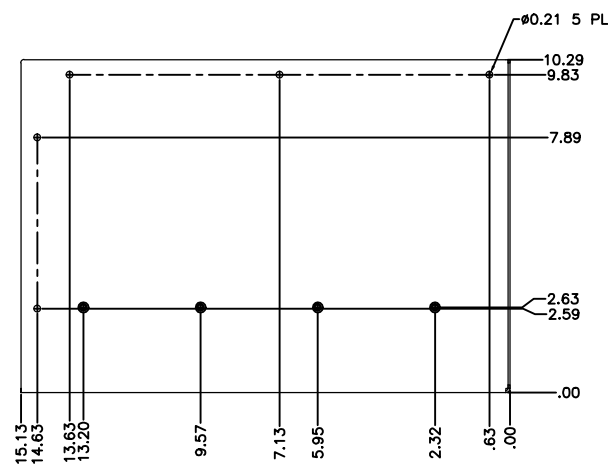
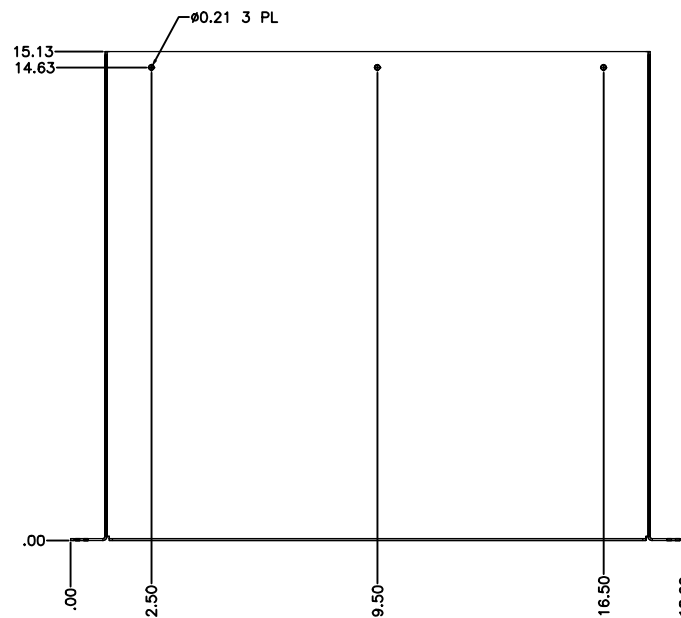

8X #0.213
INSTALL PEM NUTS
FROM FAR SIDE
#CLS-832-2

NOTES:

- UNLESS OTHERWISE SPECIFIED, ALL DIMENSIONS ARE IN INCHES.
- ALL SURFACES MUST BE CLEANED OF ALL GREASE, OIL, AND OTHER CONTAMINANTS AFTER FABRICATION. PREP. FINISHED PART TO AVOID SUBSEQUENT CONTAMINATION FROM HANDLING.
- ALL SURFACES TO BE MACHINED AND/OR FINISHED. UNFINISHED SURFACES ARE NOT ACCEPTABLE.
- MARK (INDELIBLE INK NON-VACUUM PARTS) PART NUMBER/REV. IN CAPITALS, 0.375" HIGH IN APPROX. LOCATION INDICATED BY REF. LEADER.
- FINISH - POWDER COAT DUPONT SKY WHITE PFW-510-S9, TGIC-POLYESTER, GLOSS 85-95%.

UNLESS OTHERWISE SPECIFIED DIMENSIONS ARE IN INCHES. TOLERANCES ARE: DECIMALS .XX ± .01 .XXX ± .005 .XXXX ± .0010 ANGLES ± 1° MACHINE FINISH 32/		APPROVALS DRAWN JD/ADM ENG.	DATE 30OCT12	TITLE CHASSIS, MOTION CONTROL, 8U	
DO NOT SCALE DRAWING INTERPRET DIM AND TOL PER ASME Y14.5M-1994		THIRD ANGLE PROJECTION		SIZE C	DRAWING TYPE DWG NO K17218022
MATERIAL .0478 MILD STEEL		REMOVE ALL BURRS AND SHARP EDGES		SCALE NONE	REV 01
FINISH SEE NOTE 5				SHEET 1 OF 1	